

HP 16 Large Diameter (LD) Epoxy Fittings

(232 psi unless noted)



Standard 90° Elbow

(Bell x Bell)

Pipe Size		A		X ⁽¹⁾		Weight	
in	mm	in	mm	in	mm	lbs	kg
18	450	21.75	552	8.0	203	140	64
20	500	25.25	641	9.1	231	200	91
24	600	29.00	737	10.0	254	250	114
30	750	36.50	927	13.9	353	450	204
36	900	43.50	1,105	16.8	427	800	364

Long Radius 90° Elbow

(Bell x Bell, Long Radius 1.5D)

Pipe Size		A		X ⁽¹⁾		Weight	
in	mm	in	mm	in	mm	lbs	kg
18	450	36.75	933	8.0	203	167	76
20	500	42.25	1,073	9.1	231	225	102
24	600	50.00	1,270	10.0	254	258	117

Standard 45° Elbow

(Bell x Bell)

Pipe Size		A		X ⁽¹⁾		Weight	
in	mm	in	mm	in	mm	lbs	kg
18	450	14.75	375	8.0	203	100	45
20	500	17.60	447	9.1	231	140	64
24	600	20.20	513	10.0	254	200	91
30	750	24.80	630	13.9	353	375	170
36	900	29.40	747	16.8	427	700	318
42	1050	35.30	897	18.7	475	1,100	500

Long Radius 45° Elbow

(Bell x Bell, Long Radius 1.5D)

Pipe Size		A		X ⁽¹⁾		Weight	
in	mm	in	mm	in	mm	lbs	kg
18	450	20.90	531	8.0	203	100	45
20	500	24.70	627	9.1	231	135	61
24	600	28.90	734	10.0	254	155	70

30° Elbow

(Bell x Bell)

Pipe Size		A		X ⁽¹⁾		Weight	
in	mm	in	mm	in	mm	lbs	kg
30	750	21.90	556	13.9	353	300	136
36	900	25.90	658	16.8	427	600	272
42	1050	30.60	777	18.7	475	950	431

22.5° Elbow

(Bell x Bell)

Pipe Size		A		X ⁽¹⁾		Weight	
in	mm	in	mm	in	mm	lbs	kg
30	750	20.50	521	13.9	353	250	113
36	900	24.30	617	16.8	427	525	238
42	1050	31.90	810	18.7	475	800	363

11.25° Elbow

(Bell x Bell)

Pipe Size		A		X ⁽¹⁾		Weight	
in	mm	in	mm	in	mm	lbs	kg
30	750	19.10	485	13.9	353	225	102
36	900	22.30	566	16.8	427	450	204
42	1050	28.20	716	18.7	475	675	306

⁽¹⁾ This is a nominal make-up dimension for drawing layout work only. Do not use for assembly dimensions.

NOTE: When rated according to ASTM D5685 criteria, the pressure rating for 36" diameter and smaller fittings is 16 bar and the pressure rating for 42" is 14 bar.

When rated according to ISO 14692, the pressure rating for 30" and 36" is 14.7 bar and the pressure rating for 42" is 12.7 bar

View of Fitting Illustrations

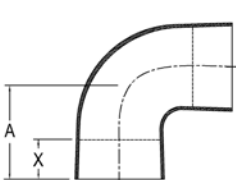

90° Elbow

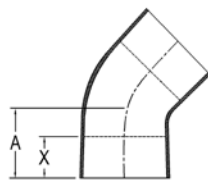

45° Elbow

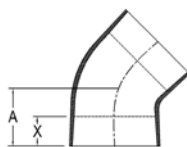

30° Elbow

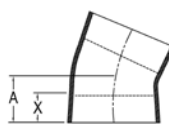

22.5° Elbow

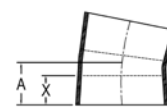

11.25° Elbow

Tees

(Bell x Bell x Bell)

Pipe Size		A		X ⁽¹⁾		Weight	
in	mm	in	mm	in	mm	lbs	kg
18	450	22.38	568	8.0	203	320	145
20	500	26.25	667	9.1	231	360	163
24	600	28.00	711	10.0	254	450	204
30	750	36.50	927	13.9	353	750	340
36	900	40.50	1,029	16.8	427	1,200	545

Sleeve Coupling

(Bell x Bell)

Pipe Size		A		X ⁽¹⁾		Weight	
in	mm	in	mm	in	mm	lbs	kg
18	450	21.00	533	8.0	203	51	23
20	500	26.00	660	9.1	231	76	35
24	600	29.50	749	10.0	254	122	55
30	750	35.00	889	13.9	353	200	91
36	900	41.00	1,041	16.8	427	320	145
42	1050	46.00	1,168	18.7	475	500	227

Reducing Tees

Pipe Size		AT		AS		X ₁ ⁽¹⁾		X ₂ ⁽¹⁾		Weight	
in	mm	in	mm	in	mm	in	mm	in	mm	lbs	kg
18 x 14	450 x 350	22.38	568	20.50	521	8.0	203	6.4	163	280	127
18 x 16	450 x 400	22.38	568	21.00	533	8.0	203	6.6	167	300	136
20 x 16	500 x 400	26.25	667	22.50	572	9.1	231	6.6	167	320	145
20 x 18	500 x 450	26.25	667	22.75	578	9.1	231	8.0	203	340	154
24 x 18	600 x 450	28.00	711	25.25	641	10.0	254	8.0	203	400	182
24 x 20	600 x 500	28.00	711	27.75	705	10.0	254	9.1	231	420	191

Concentric Reducers

(Bell x Bell)

Pipe Size		A		X ⁽¹⁾		X ⁽²⁾		Weight	
in	mm	in	mm	in	mm	in	mm	lbs	kg
18 x 16	450 x 400	28.75	730	8.0	203	6.8	173	110	50
20 x 18	500 x 450	32.00	813	9.1	231	8.0	203	140	64
24 x 20	600 x 500	46.25	1,175	10.0	254	9.1	231	190	86
30 x 24	750 x 600	50.50	1283	13.9	353	10.0	254	300	136
36 x 30	900 x 750	56.00	1422	16.8	427	13.9	352	450	205
42 x 36	1050 x 900	61.50	1562	18.7	475	16.8	428	750	340

Nipples

(X = Available Lengths)

Pipe Size		Overall Length		
in	mm	24" (610 mm)	36" (914 mm)	42" (1067 mm)
18	450	X	X	
20	500	X	X	
24	600		X	
30	750		X	
36	900			X
42	1050			X

NOTE: When rated according to ASTM D5685 criteria, the pressure rating for 36" diameter and smaller fittings is 16 bar and the pressure rating for 42" is 14 bar.

When rated according to ISO 14692, the pressure rating for 30" and 36" is 14.7 bar and the pressure rating for 42" is 12.7 bar

View of Fitting Illustrations

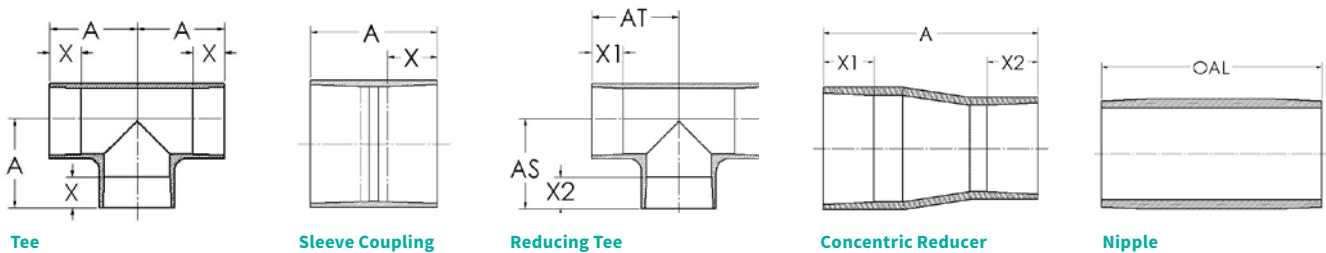

Flanges

(Filament Wound (FW) and Blind Flange ANSI B16.5 Class 150)

Pipe Size	B		C		CC		D		E Bold Hole Size Number of Bolts		O		FW Flange X ⁽¹⁾		Bolt Torque		FW Flange Weight		Blind Flange Weight		
	in	mm	in	mm	in	mm	in	mm	in	mm	in	mm	in	mm	ft-lbs	N-m	lbs	kg	Blind	kg	
18	450	9.0	229	2.75	70	2.50	64	22.75	578	1.25 - 16	32 - 16	25.0	635	6.8	173	200	271	76	35	125	57
20	500	11.0	279	2.75	70	2.75	70	25.00	635	1.25 - 20	32 - 20	27.5	699	7.8	198	200	271	92	42	140	64
24	600	13.0	330	3.00	76	3.31	84	29.50	749	1.38 - 20	35 - 20	32.0	813	9.5	241	200	271	124	56	155	70

⁽¹⁾This is a nominal make-up dimension for drawing layout work only. Do not use for assembly dimensions.

Van Stone Flanges

(ANSI B16.5 Class 150 (18"-24"), ANSI B16.1 Class 125 (30"-42"))

Pipe Size	A		B		X ⁽¹⁾		D		E		F		G		H		I		Max. Bolt Torque		Nom. Weight Hub		Nom. Weight Bolt Ring		
	in	mm	in	mm	in	mm	in	mm	in	mm	in	mm	in	mm	in	mm	in	mm	ft-lbs	N-m	lbs	kg	lbs	kg	
18	450	21.4	545	19.9	506	7.5	191	9.00	229	8.50	216	2.25	57	1.25	32	22.75	578	25.00	635	200	271	39	18	98	44
20	500	23.7	602	21.9	557	8.5	216	9.88	251	9.38	238	2.25	57	1.25	32	25.00	635	27.50	699	200	271	53	24	114	52
24	600	28.1	713	25.9	658	10.0	254	11.75	298	11.25	286	2.25	57	1.38	35	29.50	749	32.00	813	200	271	79	36	140	64
30	750	34.6	880	N/A	N/A	10.0	254	10.00	254	9.50	241	2.25	57	1.38	35	36.00	914	38.75	984	400	543	121	55	192	87
36	900	41.1	1043	N/A	N/A	13.0	330	13.00	330	12.50	318	2.25	57	1.63	41	42.75	1,086	46.00	1,168	400	543	208	94	270	122
42	1050	47.8	1214	N/A	N/A	19.5	495	19.50	495	19.00	483	3.00	76	1.63	41	49.50	1,257	53.00	1,346	400	543	440	200	445	202

⁽¹⁾All 18" - 42" (450-1050 mm) Van Stone Flanges will have to be custom fit to spigot.

Saddles

Pipe Size		A		B		C		X ₁ ⁽¹⁾ W/RT Pipe		X ₁ ⁽¹⁾ W/GT Pipe	
in	mm	in	mm	in	mm	deg	in	mm	lbs	kg	
18 x 2	450 x 50	12.75	324	13	330	90	1.6	41	1.6	41	
18 x 3	450 x 75	13.25	381	15	337	90	1.8	46	1.9	48	
20 x 2	500 x 50	13.75	349	13	330	90	1.6	41	1.6	41	
20 x 3	500 x 75	14.25	362	15	381	90	1.8	46	1.9	48	
24 x 2	600 x 50	16.00	406	13	330	70	1.6	41	1.6	41	
24 x 3	600 x 75	16.25	413	15	381	70	1.8	46	1.9	48	

⁽¹⁾This is a nominal make-up dimension for drawing layout work only. Do not use for assembly dimensions.

NOTE: When rated according to ASTM D5685 criteria, the pressure rating for 36" diameter and smaller fittings is 16 bar and the pressure rating for 42" is 14 bar.

When rated according to ISO 14692, the pressure rating for 30" and 36" is 14.7 bar and the pressure rating for 42" is 12.7 bar

View of Fitting Illustrations

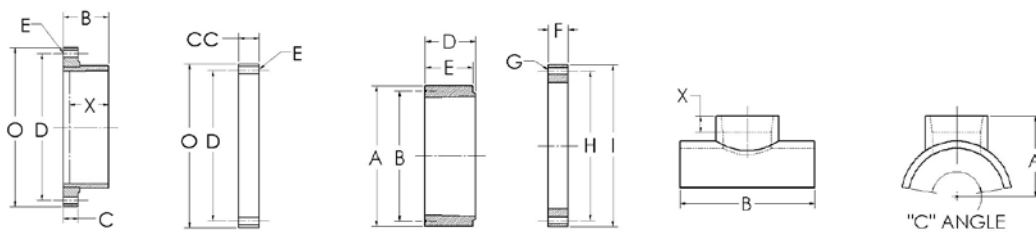

Flange - Filament Wound / Blind

Van Stone Flange

Saddle

National Oilwell Varco has produced this brochure for general information only, and it is not intended for design purposes. Although every effort has been made to maintain the accuracy and reliability of its contents, National Oilwell Varco in no way assumes responsibility for liability for any loss, damage or injury resulting from the use of information and data herein nor is any warranty expressed or implied. Always cross-reference the bulletin date with the most current version listed at the web site noted in this literature.

Fiber Glass Systems

17115 San Pedro Avenue, Ste 200
San Antonio, Texas 78232 USA
Phone: 210 477 7500
Fax: 210 477 7560

© 2016 National Oilwell Varco All Rights Reserved
C11351ENG June 2016